

A modern living room with light wood flooring, a dark grey sectional sofa, a tall white floor lamp, and a long wooden coffee table. Large windows and sliding glass doors provide a view of a balcony and surrounding greenery. A white media console is visible on the right.

HIGH-QUALITY WINDOWS & DOORS

ENERGATE 

HIGH-QUALITY WINDOWS & DOORS

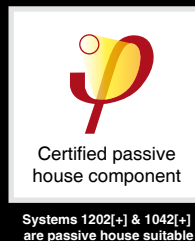

SYSTEMS:

WOOD ALUMINIUM:

ENERGATE 1202+ · ENERGATE 1202 · ENERGATE 963

WOOD:

ENERGATE 1042+ · ENERGATE 1042 · ENERGATE 802

EXCELLENT THERMAL INSULATION:

SYSTEM	1202+ & 1042+ WOOD ALUMINIUM & WOOD	1202 & 1042 WOOD ALUMINIUM & WOOD	963 & 802 WOOD ALUMINIUM & WOOD
U_i - W/m ² K	0,73*	0,98*	1,2*
U_w - W/m ² K	0,66*	0,74*	0,8*

Systems 1202+ & 1042+ and 1202 & 1042 are passive house suitable.

* Values specified are calculated for tested window: Dual action, single opening window with triple insulating glass $U_g = 0,5$ W/m²K · Window Size: 1,23 x 1,48 m · Norm: EN ISO 10077- 1

SPECIFICATIONS:

- Solid wood window or with additional insulation
- Triple insulating glass $U_{glazing} = 0,5$ W/m²K with special fibreglass spacer
- Our system has been successfully tested during many blower door tests
- Certification by accredited testing facilities
- All products are CE-certified
- Solvent free water-based three-layer wood coating system
- Two continuous gaskets
- Timber type: Spruce, larch, oak
- Aluminium cladding with plugged corner connection with welded corners available
- Many product types: A variety of functions

WOOD ALUMINIUM WINDOWS

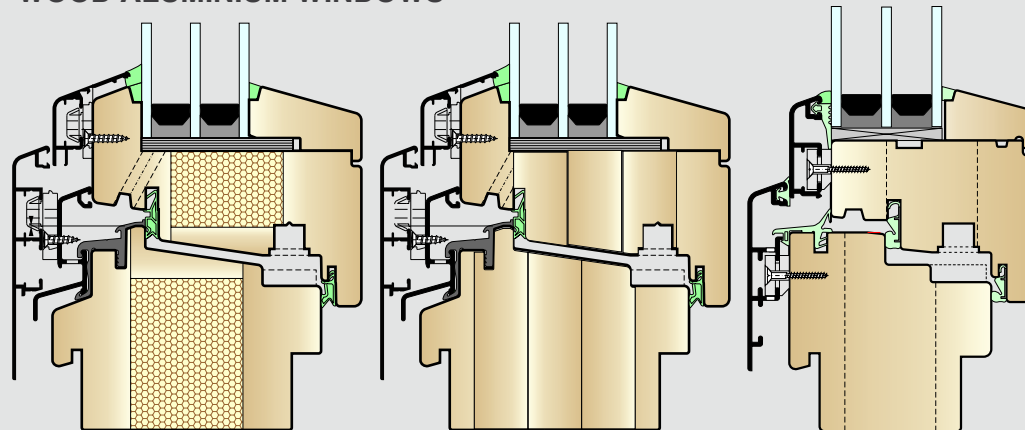

ENERGATE 1202+

ENERGATE 1202

ENERGATE 963

WOOD WINDOWS

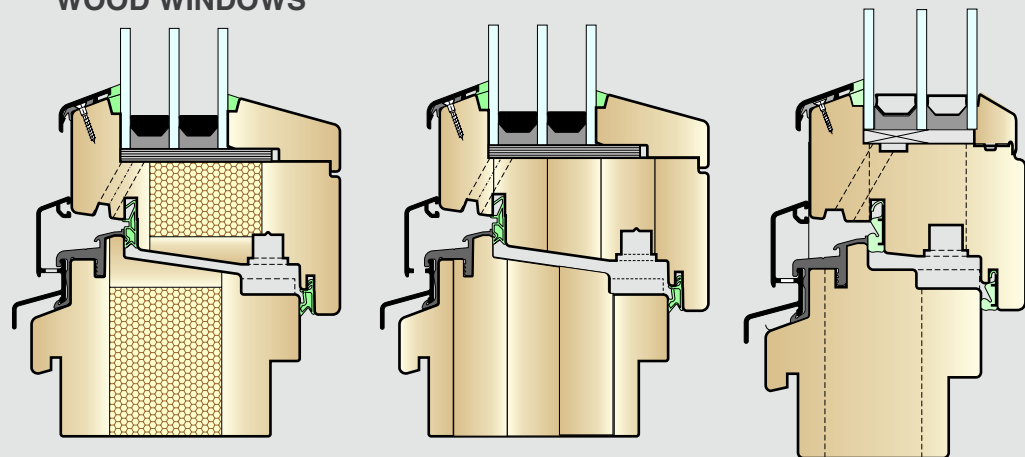

ENERGATE 1042+

ENERGATE 1042

ENERGATE 802



Triple insulating glass

Triple insulating glass with
 $U_g = 0,5$ W/m²K

➤ Fiber glass spacer · Color: black

In case of obscure or ornamental glass, it will be on the middle of the insulated glass unit

SPECIFICATIONS



Winner of Solar Decathlon · Architects: Technische Universität Darmstadt · Germany

Product group	Product type	MATERIAL: WOOD ALUMINIUM	MATERIAL: WOOD	MATERIAL: WOOD ALUMINIUM & WOOD
		SYSTEM: 1202+ & 1202	SYSTEM: 1042+ & 1042	SYSTEM: 963 & 802
1.000	Windows	<input checked="" type="checkbox"/>	<input checked="" type="checkbox"/>	<input checked="" type="checkbox"/>
1.100	Patio doors with flat threshold	<input checked="" type="checkbox"/>	<input checked="" type="checkbox"/>	<input checked="" type="checkbox"/>
1.021	fixed window	<input checked="" type="checkbox"/>	<input checked="" type="checkbox"/>	<input checked="" type="checkbox"/>
5.000	Lockable patio doors with flat threshold	<input type="checkbox"/>	<input checked="" type="checkbox"/>	<input checked="" type="checkbox"/>
7.000	Folding sliding doors	<input type="checkbox"/>	<input checked="" type="checkbox"/>	<input checked="" type="checkbox"/>
8.000	Lift & sliding doors	<input type="checkbox"/>	<input type="checkbox"/> <input checked="" type="checkbox"/>	<input checked="" type="checkbox"/>
X.XXX.3 -.4	Outwards opening	<input type="checkbox"/>		<input checked="" type="checkbox"/>

☒ = availbe
 ☐ = not availbe

X.X22-X.X27	Arched windows	not availbe in + systems with PUR core
	Concealed hinges	available for product from group 1.000

Wood - Colorsystem: SPRUCE - Picea Abies



Wood - Colorsystem: OAK & LARCH



Standard product types

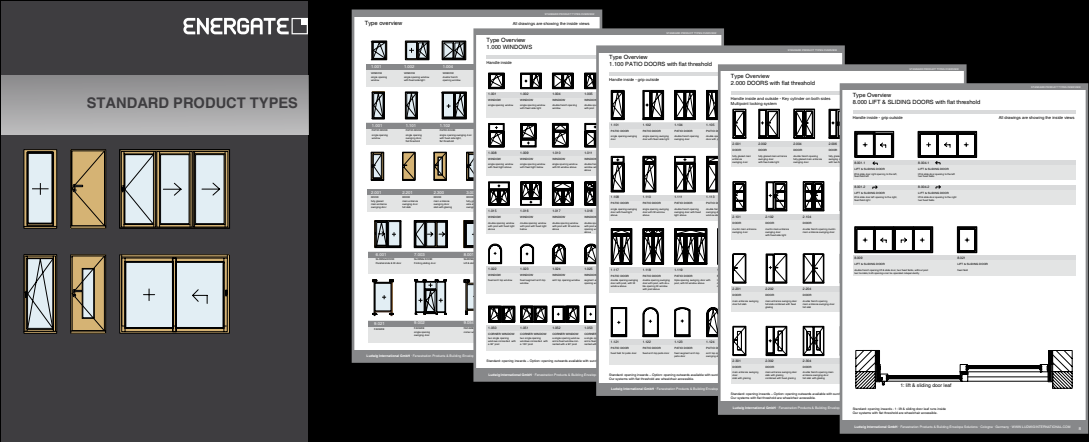

Aluminum - Standard Colors







HIGH QUALITY MAIN ENTRANCE DOORS



Certified passive
house component

System PH
is passive house suitable

Door leaf made of multilayer board

- Thermal transmittance of the door blank $_{up\ to} = 0,93\ W/m^2K$ (Spruce)
- ALU Cladding Exterior
- Door leaf: Aluminum panel 3 mm thickness
- Door frame: Aluminum profile - clipped
- Door leaf made of multilayer board, strengthened with solid wood frame and integrated stabilizers against default
- Excellent thermal insulation U_d (depending on model, spruce) up to $1,0\ W/m^2K$
- 2 gaskets all around 3-point locking with 3-dimensional-adjustable special hinges
- Durable function: All our doors pass 200.000 opening and closing cycles in the long time test
- DIN-EN-Norm tested
- Bullet-resistant for special safety claims upon request
- Considerably tested with a standard tool set to burglary safety
- Wood choices: Spruce, larch, oak

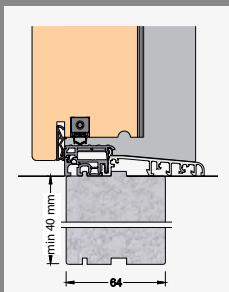

For Thermal optimal results, we recommend 40mm frame extension as thermal divider between inside and outside.

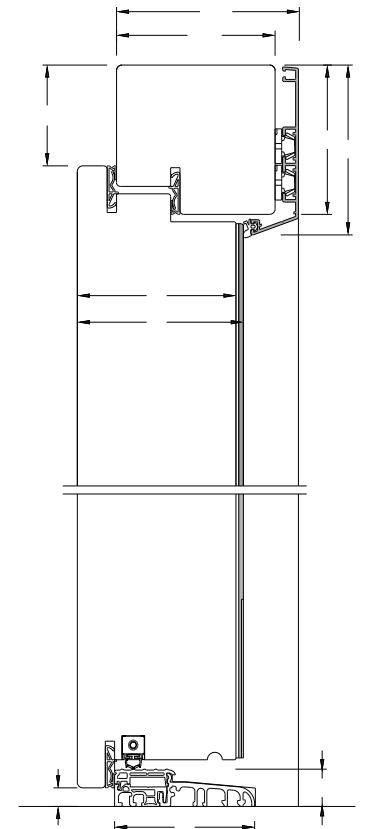





Ludwig International GmbH
Fenestration Products & Building Envelope Solutions
Cologne · Germany

Window cutting sections are not to scale and for illustration purposes only.
For technical reasons, the colors shown on these pages are not authoritative.
Color deviations from the original are depending on the printing conditions.

We reserve the right to make technical changes.